

Schuyler

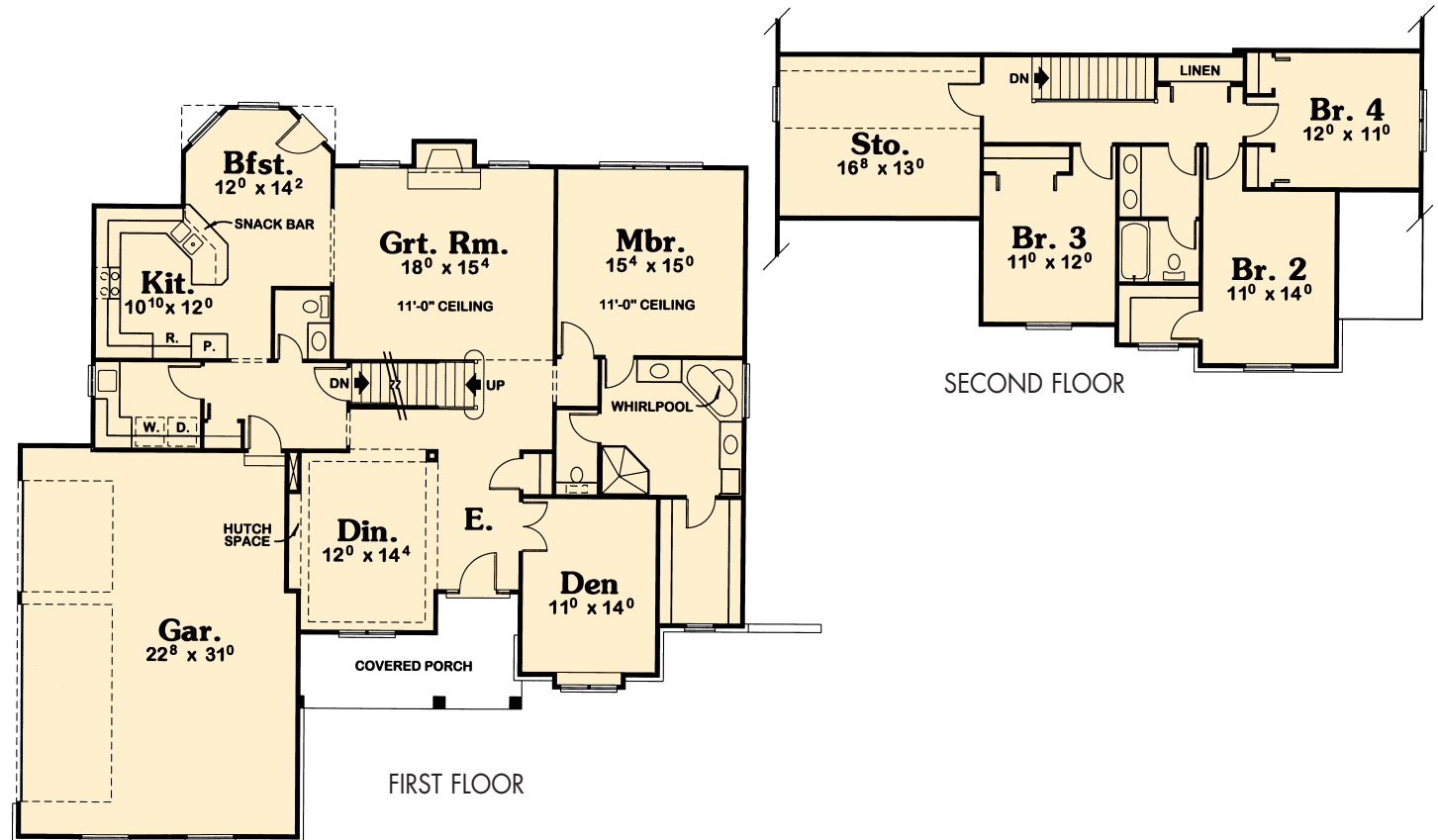

- Timeless details in unique proportions give this design its eclectic edge.
- Adding glamour to the entry, the dining room features a hutch space.
- When entertaining, the den with double doors makes a wonderful companion to the dining room.
- Bayed windows brighten the breakfast area which is open to the kitchen with a peninsula snack bar.
- A porthole window set under a double gable end naturally draws attention to the entry below. Sturdy columns were designed to announce the beautiful front door adorned with a transom and sidelights.



MODEL NO. 4134-40R
 1-1/2 STORY
 4 Bedrooms + Den ♦ 2½ Baths
 Length60'-0"
 Depth.....59'-4"
 First Floor1,847 sq. ft.
 Second Floor.....766 sq. ft.
 Total Area.....2,613 sq. ft.